

# LET MILLWORK MART DESIGN YOUR NEW KITCHEN

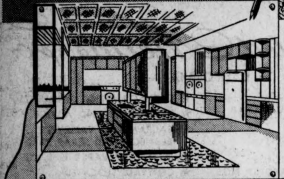

Millwork Mart experts take all the work out of designing and installing a modern, efficient kitchen that will bring bright new beauty and convenience to your home! We manufacture both standard and custom kitchens... available at direct-from-mill-to-you savings. See our handsome kitchen displays today.

PHONE GI 3-5991

CONSULT OUR EXPERTS  
We Are Equipped to Plan, Produce and Install  
A New Kitchen, Bedroom, Den or Recreation Room  
EASY MONTHLY PAYMENTS - PLenty of AVAILABLE PARKING  
Open 8 A.M. to 5 P.M. Daily - 10 A.M. to 5 P.M. Saturday

MILLWORK MART

103 T STREET

→ Codes in listings indicate communities as follows: Sacramento (No Code) Carmichael (C) North Highlands (NH) West Sacramento (WS)  
Sacramento (No Code) Sacramento (No Code) Sacramento (No Code) Sacramento (No Code)

## Kitchen Equipment

A & A Key & Builders Supply  
2700 Stockton Bl. ----- GL 2-1471  
Art's Cabinet Shop 2509 Tower Av. IV 7-8379  
Beautymade Plastic Products Co.  
1629 Howe Av. ----- WA 5-1812  
Bramow J P Tile Co  
819 Scamias St. ----- HI 2-8156  
CAPITAL SHEET METAL WORKS  
200 P-GI 3-5504  
Century Metalcraft Corp  
2417-27th GL 6-5135  
CUSTOM PLASTICS PRODUCTS  
1420 Cannon (NS)-WA 2-7074  
Cut Rate Plumbing Supply Co  
333 N 12th-GI 3-3987  
Cutto Cutlery-Division of Wear-Ever  
Aluminum Linc 2304-14th ----- GI 1-4096  
Dave's Cabinet and Fixture Co  
4315 Auburn Bl. ----- IV 3-5711

Your telephone is one of today's best bargains.

DECORATING SERVICE  
All Major Lines of Appliances  
No Job Too Large or Too Small  
FREE ESTIMATES  
DINETTE SETS  
All Our Appliances and Work  
Fully Guaranteed and Serviced  
COMPLETE REMODELING

## BUDGET TERMS



**Horrell & Son, Inc.**  
Horrell - McIntyre & Boothby

PHONE  
Gladstone 2-6581

## CUSTOM DESIGNED KITCHENS, BATHROOMS

1213 ALHAMBRA BLVD.  
SERVING ALL OF  
NORTHERN CALIFORNIA  
RELIABILITY 45 YEARS EXPERIENCE

## PAY-LESS BUILT-IN KITCHENS TILE & FORMICA TOPS

Wholesale Distributor For KITCHEN APPLIANCES  
MANUFACTURERS OF CUSTOM CABINETS & PULLMANS  
DESIGNED & INSTALLED  
Or Do-It-Yourself with Our Help  
Come in & See Our Complete Display  
FREE ESTIMATES - EASY TERMS  
Quality & Service

## PAY-LESS BUILDERS SUPPLY



YAC  
Bart  
Payless  
Builders  
Supply  
Kitchen  
Bath

IV 3-5113

2501 TOWER AVE.

## DURATILE OF CALIF

Kitchen & Bathroom Remodeling  
Free Estimates & Planning Service  
Plastic, Metal & Clay Tile - Linoleum  
4601 N ----- GL 1-9451

## ECONOMY APPLIANCE SALES

FRIGIDAIRE  
Built-In Kitchen Appliances  
WE INVITE YOU TO VISIT OUR  
SHOW ROOMS  
TWO LOCATIONS TO SERVE YOU  
Retail & Wholesale  
2025 Arden Wy. ----- WA 2-3401  
2601 J ----- GI 2-2949

(Continued Next Page)

GREASE BEFORE USING  
Caps of nail polish and glue bot-  
tles won't stick if the screw threads  
are greased with cold cream or oil.

## Kitchens

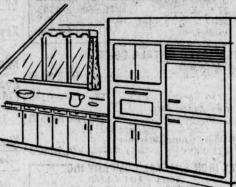

## Kitchen Equipment-(Cont'd)

### GENEVA STEEL KITCHENS

Beasty and unmatched  
quality combine to make  
Geneva cabinets and sta-  
less steel sinks a sound  
kitchen investment. Avail-  
able in six delightful col-  
ors or white. Wood fronts if  
you prefer. Compare  
before you buy.

"WHERE TO BUY THEM"

DEALERS  
HORRELL & SON  
1213 Alhambra Bl. ----- GL 2-6581

DISTRIBUTORS  
Arrigo A  
919 Anita Ct Lafayette-ATInte 3-8623

GORDON DOUGLAS W  
550 Pala Wy. ----- GL 6-5025  
HORRELL & SON  
1213 Alhambra Bl. ----- GL 2-6581  
(See Advertisement Page 292)  
Kitchen Designers The 2601 J ----- HI 7-1113

## KITCHEN MAID KITCHENS

Hardwood Cabinets in  
beautiful stains & soft  
or, with many feature  
cabinets & distinctive  
styling.  
Trained personnel for your Kitchen problems.  
"It's Kitchen Maid, it's the best."

"WHERE TO BUY THEM"

DISTRIBUTORS  
PAC KITCHEN SUPPLY  
989-40th Oakland ----- Olympic 4-3683

KUSTOM KITCHENS 915-20th ----- GI 8-6773  
McDermott J T Tile Co  
700-57th GL 1-8481

MILLWORK MART 103 T ----- GI 3-5991  
(See Advertisement Page 292)

PAY-LESS BUILDERS SUPPLY  
2501 Tower Av. ----- IV 3-5113  
(See Advertisement Page 292)

Richardson Bros  
See Ad Contra Alteration  
2740-19th Av. ----- GL 6-1030

ROMACK PLUMBING CO  
Kitchen & Bathroom Remodeling  
Free Estimates - Planning Service  
General Electric Appliances  
1313 Broadway ----- GI 3-1701

## ST CHARLES CUSTOM KITCHENS

Designed to the exact needs  
of your family. Choice of styl-  
ing, colors, materials, con-  
venience features and layout.  
We are prepared to plan, in-  
stall & coordinate all trades  
needed for completing your  
kitchen. Visit our showroom.

"FOR INFORMATION CALL"

KITCHEN DESIGNERS THE  
Walter Ford & Assoc  
2601 J ----- HI 7-1113

SALADMASTER PRODUCTS  
620 I-GI 1-2641

SCHMIDT & CZECH CABINET SHOP  
Dias Av-GA 8-7300

TAKOES MILLWORK CO  
Exclusive Coll. Distr. for  
MORGAN Kitchen Cabinets  
Complete Stock of MORGAN Kitchen  
Cabinets in Philippine Mahogany &  
White Birch With Complete Line  
of Accessories and Finishes  
FULL LINE OF  
FACTORY COUNTER TOPS  
DUCTLESS HOODS  
STOCK VANITIES  
830 Riske Ln(Ws) ----- FR 1-9250

## Kitchen Equipment-(Cont'd)

### VILLAGE CABINET SHOP

2820 Pope Av. IV 9-3168

### WILLIFORD'S

FOR A  
BEAUTIFUL KITCHEN  
Call  
----- GI 1-4051

## YOUNGSTOWN KITCHENS

Cabinet Sinks  
Base Cabinets  
Wall Cabinets  
Dishwashers  
Food Waste Disposers  
Built-In Ranges  
and Ovens  
Serv-Center  
DIVISION OF  
AMERICAN STANDARD

"WHERE TO BUY THEM"

DEALERS  
HORRELL & SON  
1213 Alhambra Bl. ----- GL 2-6581

## Kitchen Remodeling

See Contractors-Alteration; Kitchen Equipment

## Knife Sharpening-See Sharpening Service

## Knit Goods-Blocking-See Cleaners & Dyers

## Knit Goods-Repairing-See Reweaving

## Knitted Fabrics

Harriet's Reweaving & Alterations  
1431-29th GL 6-3334

## Knitting Instruction

Lanai Yarn Shop 5675 Freeport Bl-GA 1-1906  
Yarn Barn 5811 Marconi Av(C)-IV 7-8102

## Knitting Machines

SPEED-O-KNIT KNITTING MACHINE  
Amazing Home Knitting Ma-  
chine makes "Hand Knit" in  
minutes. Knits with the speed  
of 200 needles.  
Knit a sweater in 5 hours.  
Knit a complete suit in less  
than 3 days. Learn to op-  
erate in 1/2 hour!

"FOR INFORMATION CALL"

DEALERS  
SACRAMENTO SEWING MACHINE CO  
1022 J-GI 8-1683

YARN BARN  
5811 Marconi Av(C)-IV 7-8102

## Knives-See Cutlery Hdgs

## Knives-Machine

BARNETT FRED E CO  
999 Arden Wy(NS)-WA 2-5621  
M & M SAW & KNIFE WORKS  
1711-2d-GI 2-4545

## Knives-Sharpening

See Sharpening Service

Don't forget to plan for con-  
cealed telephone conduit and  
convenient locations for telephone  
outlets when you build your new  
home. These built-in telephone fa-  
cilities add real value to a home,  
yet their cost is very small if they  
are installed during construction.

## Labels

Dennis & Son U S Tag & Label Co  
1820 Broadway ----- GI 2-4561

## EASTMAN LABELS

GUMMED - HEAT SEAL  
PRESSURE SENSITIVE  
PAPER - FULL  
LABELS - SEALS -  
BAG TOPS.  
Pioneer Tag Makers of the West Coast  
Since 1914

"FOR INFORMATION CALL"

Eastman Tag & Label Co  
1435 Alhambra Bl-GI 2-2030

Schmidt Lithograph Co  
Lithograph Only  
1601 J ----- GI 8-2709

## Labor Contractors

BALDERAMA O Elverta Rd ----- WA 5-8446  
MARTINEZ RUFAS G  
Mailing Address Rt 1 Box 90  
Clarksburg ----- FR 1-5588

## Labor Organizations

BAKER'S & CONFECTIONER'S UNION  
NO 85 2525 Stockton Bl ----- GI 1-0177  
Barbers Union Local 112  
2811 Capitol Av ----- GL 7-4022

Bartender's Union Local 600  
901-19th-GI 2-6806  
Thomas Peterson-Sec-Res ----- GA 1-0766  
Ray McCarthy-Bus Agent-Res ----- HI 6-2279

BOILERMAKERS LOCAL 94  
1109 Rose Ct(Ws)-FR 1-7940  
Brick Layers Union No 9 1245-33d-GI 1-2062  
Brotherhood of Railway Trainmen  
926 J-HI 6-7114

Brotherhood of Railroad Car-  
men Bldg. GL 2-4809  
Brotherhood of Railway Clerks WP System  
2525 Stockton Bl ----- IV 9-0885  
Building & Construction Trades Council of  
Sacto-Yolo Counties  
2525 Stkn Blvd-GL 5-2623

Building Service Emp Union Local 22  
Howard Fites Sec Treas  
713 K ----- GI 2-3050

BUTCHER'S UNION LOCAL NO 498  
1st & 3rd Tues-Roy Mack-Bus Mgr  
819 T ----- HI 6-5223  
C E L & T Association  
2525 Stockton Blvd-GL 1-0521

Campbell W J 5841 Newman Ct ----- GL 5-2613  
CANNERY WORKERS & WAREHOUSEMEN  
UNION LOCAL 857 A F L  
Ofc Hrs 8 AM-5 PM Mon Thru Fri  
Meetings 1930 G St  
First Friday of Each Month  
1930 G ----- GI 3-6593

Carpenters Local 2170  
2525 Stockton Bl ----- GL 5-5165  
CARPENTERS SACTO-YOLO DISTRICT  
M B Bud Bryant-Bus Agent  
2525 Stockton Bl ----- GL 6-4726

Carpel Linoleum & Soft Tile Workers  
Local 1227 5351 Whittier Dr ----- GL 1-8220  
Cement Masons Local No 582  
2525 Stockton Blvd-GL 1-1731

Ceramic Tile Layers Local 29  
3833 Floral Dr(HI) ----- ED 2-5775  
Chauffeurs Teamsters & Helpers Local  
Union No 150 2525 Stockton Bl ----- GL 6-3812

Communications Workers of America  
A F L-CIO District 9  
Marinda Heinig-CWA Rep  
3139-17th ----- GL 8-7770

Communications Workers of America CIO  
Local 9421 1007-30th ----- GI 5-5536  
CONSTRUCTION & GENERAL LABORER'S  
UNION LOC NO 185  
2525 Stockton Bl-GL 7-9086

Cook's Pastry Cook's & Pantymen's Union  
Local 683  
Barney Jackson-Secretary  
8441 Newman Ct ----- GI 5-2719

Electrical Workers' Union No 340  
W J Campbell-Bus Mgr  
5841 Newman Ct ----- GL 5-2613

FOOD PROCESS WORKERS &  
WAREHOUSEMAN'S UNION LOC 228  
Glen K Hedberg-Secy Treas  
6235 Franklin Bl ----- GA 8-7745

Frank E Thompson-Sect  
600-4th(B) ----- GI 8-8382

GLASS ON FLOOR?  
You can pick small fragments  
of broken glass off the floor with  
a wet cloth. (Throw the cloth  
away.)

## Labor Organizations-(Cont'd)

Glaizers Local Union 767  
C P Mahoney Bus Mgr-Fin Sec  
Call 7:30 AM to 9 AM only  
2525 Stockton Bl ----- GL 1-0201

Hod Carriers Union Loc No 262  
James F Florian-Bus Mgr  
2525 Stockton Bl ----- GL 1-1351

IRON WORKERS UNION LOCAL 118  
C R Burton-Secretary  
Meetings 1st & 3rd Friday of Each Month  
2525 Stockton Bl ----- GL 2-4317

Joint Electrical Industry Training Plan  
5841 Newman Ct ----- GL 7-3229

Lathers Union  
Robt H Worthy-Bus Mgr  
2525 Stockton Bl ----- GL 8-8003

Laundry Dry Cleaning & Dye House  
Worker's International Union Loc 75  
Albert J Rogers-President  
719 K ----- GI 2-2909

Welfare Department 719 K ----- HI 7-8466  
Local Joint Executive Board of Culinary  
Workers Barbers & Hotel Service  
Employees  
Ofc Hrs Monday Thru Friday 8-5 PM  
2600 J ----- GI 8-3938

Local Union 447 Pipe Trades Trust  
Funds Office 5841 Newman Ct ----- GL 7-0621  
Lumber & Sawmill F of L Loc 2170  
Frank E Santos-Bus Agt-Labor Temple  
2525 Stockton Bl ----- GL 1-1181

Machinists Union Local 28  
1421-15th-GI 3-7495  
MECHANICS UNION LOCAL 2182  
Ofc Hrs 9 A-M to 5 P-M Mon Thru Fri  
1421-15th ----- GI 3-7495

Miscellaneous Culinary & Hotel Service  
Employees Union Loc 293 1210 H-GI 3-5903  
Musicians Union Local 12  
2525 Stockton Blvd-GL 7-5795

Painters Union Local 467  
2525 Stockton Blvd-GL 7-9801

Plasterers Union Loc 225  
W J Azevedo-Bus Mgr-Secy & Treas  
2525 Stockton Blvd ----- GL 1-2781

PLUMBERS & PIPE FITTERS LOCAL  
UNION NO 447 5841 Newman Ct-GL 7-6595  
Printing Pressmen's Union No 60  
2811 Capitol Av ----- GL 7-8896

RETAIL CLERKS' UNION LOCAL 588  
Roofers' Local No 47  
2525 Stockton Blvd-GL 2-2121

SACTO VALLEY UNION LABOR BULLETIN  
2525 Stockton Blvd-GL 6-4728  
Sacramento-Yolo Counties Central Labor  
Council AFL-CIO 1210 H ----- GL 2-4983

Sacto-Yolo District Council of Carpenters  
2525 Stockton Blvd-GL 6-4726  
Sheet Metal Workers Union Loc No 162  
1006-24th ----- GL 6-5776

STATIONARY ENGINEERS LOCAL 39  
Ofc Hrs 8:30 AM to 12:30 PM  
1006-24th ----- GL 1-2550

Teamsters Chauffeurs & Helpers Local  
Union No 150  
2525 Stockton Blvd-GL 6-3812

TEAMSTERS INTERNATIONAL  
BROTHERHOOD OF CHAUFFEURS  
WAREHOUSEMEN & HELPERS OF  
TEAMSTERS JOINT COUNCIL  
NO 38 I B T 831 H ----- GI 1-2787

Theatrical Employees B-66  
1210 H ----- GL 2-4983

Typographical Union  
2811 Capitol Av-GL 6-8537

Valley Clerks Trust Fund  
2131-28th-GL 2-3127

Waiters & Waitresses Union Local 561  
1210 H ----- GI 3-5937

WAREHOUSEMAN'S UNION LOCAL 17  
L W U  
Bus Ofc 600-4th(B) ----- GI 8-4556

Dispatcher's Ofc  
Frank E Thompson-Sect  
600-4th(B) ----- GI 8-8382